

The civic garden provides a quality urban realm shared by World heritage Site visitors and building users. It creates a foreground to the new pavilion building, a sitting terrace and viewing area, and is integrated with the wider landscape, serving as one of the pedestrian access routes to the allotment gardens to the north. Partnerships with local organisations such as 'Veg on the Edge' and Shipley Town Council will inform the development of the landscape proposals here. The landscape oriented nature of the project increases the area of the site given over to nature with benefits for biodiversity, attenuation of surface water, and the urban micro-climate.

The civic garden is enclosed by railings and can accommodate local active travel facilities including cycle stands and cycle lockers as well as providing outdoor amenity space. It is designed as a key orientation point within the World Heritage Site for visitors containing information boards and providing access to the public toilets and the heritage hub. Disabled drop off and disabled car parking spaces on Victoria Road will form part of an accessibility strategy for visitors to the World Heritage Site. The public roof terrace will be limited to daytime access.



The under-used car park on Exhibition Road
Electric vehicle charging points are available in this car park



The site of the former St John Ambulance building on Caroline Street
A poor quality foreground to the grade II* listed Salts Mill building



Allotment gardens were part of the original vision for Saltaire
The green spaces provide an attractive foreground to Salts Mill



The Caroline Street car park
Parked cars occupy an area originally intended to be a green space



Concrete, tarmac, and rusting steel railings adjacent to the public toilets
Poor quality materials in a prominent location



Mature planting defines edges around the well used allotments
There are opportunities to increase the amount of green space



A visually intrusive patchwork of tarmac
Cars currently dominate the frontage to Caroline Street



Some elements of original fabric remain intact
Original stonework and railings to Caroline Street



The original railings will be retained and refurbished
Poor quality non-original railings will be replaced

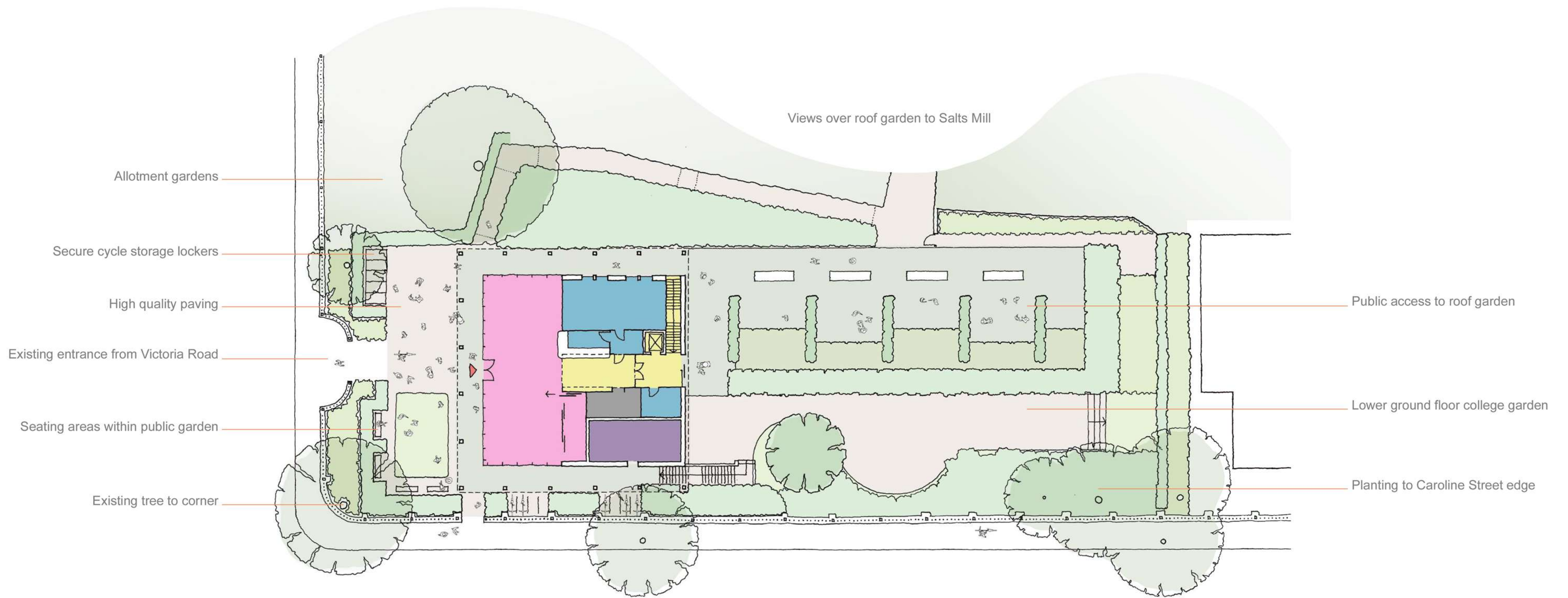

Secure cycle storage lockers



Seating within the new public garden



An enhanced landscape setting



Accessible public green spaces



Rooftop planting



Planting for improved biodiversity

gardens